

Republic of Korea

CENTRAL APRON ELEV **16** m
THE OTHER APRON ELEV **13** m

TWR	118.05	118.1	240.9
GND	121.9	121.95	
APN	129.525	130.875	131.175

**SEOUL / Gimpo INTL
RWY 14L/32R
14R/32L DEPARTURE**

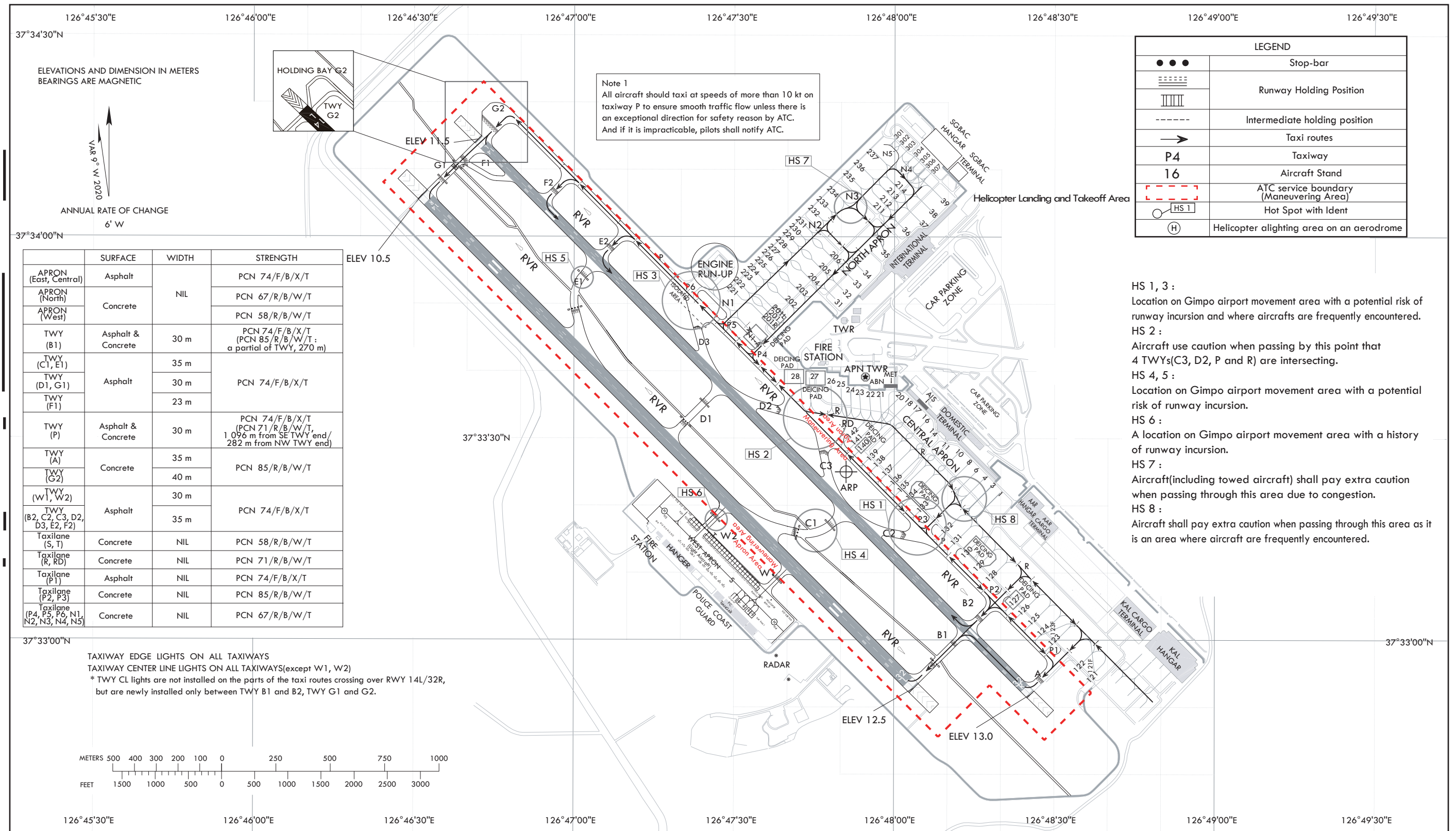

OFFICE OF CIVIL AVIATION

AIP AMDT 1/23

AERODROME GROUND
MOVEMENT CHART - ICAO

CENTRAL APRON ELEV 16 m
THE OTHER APRON ELEV 13 m

TWR	118.05	118.1	240.9
GND	121.9	121.95	
APN	129.525	130.875	131.175

SEOUL / Gimpo INTL
RWY 14L/32R
RWY 14R/32L ARRIVAL

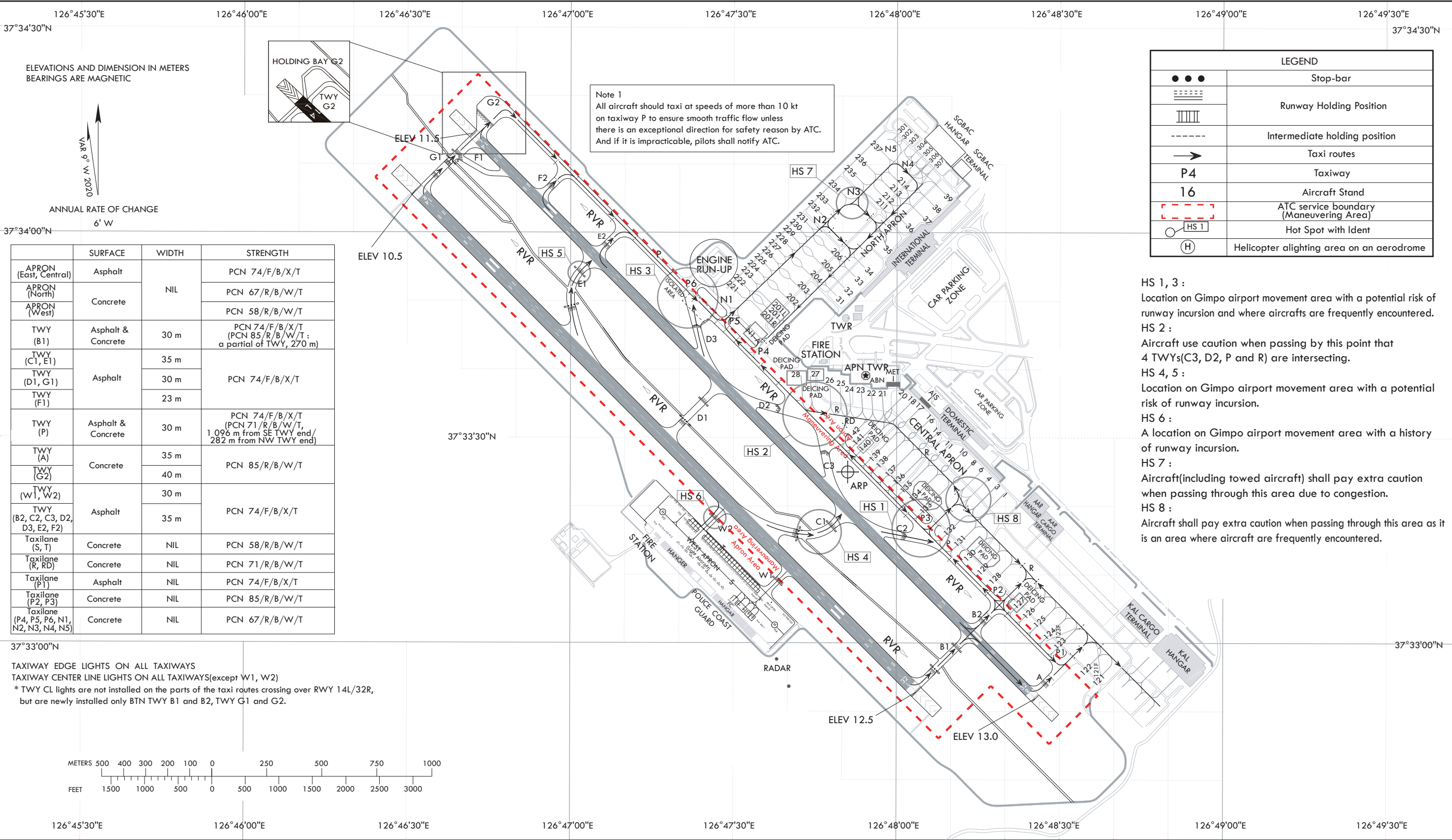

HS 1, 3 :
Location on Gimpo airport movement area with a potential risk of runway incursion and where aircrafts are frequently encountered.

HS 2 :
Aircraft use caution when passing by this point that 4 TWYs(C3, D2, P and R) are intersecting.

HS 4, 5 :
Location on Gimpo airport movement area with a potential risk of runway incursion.

HS 6 :
A location on Gimpo airport movement area with a history of runway incursion.

HS 7 :
Aircraft(including towed aircraft) shall pay extra caution when passing through this area due to congestion.

HS 8 :
Aircraft shall pay extra caution when passing through this area as it is an area where aircraft are frequently encountered.

Change : Establishment of taxilane RD and Information of TWY, lead in · lead out line, intermediate holding position.